

**INSTRUCTIONS FOR USE AND INSTALLATION  
GAS STOVE  
GAR 14 XL**

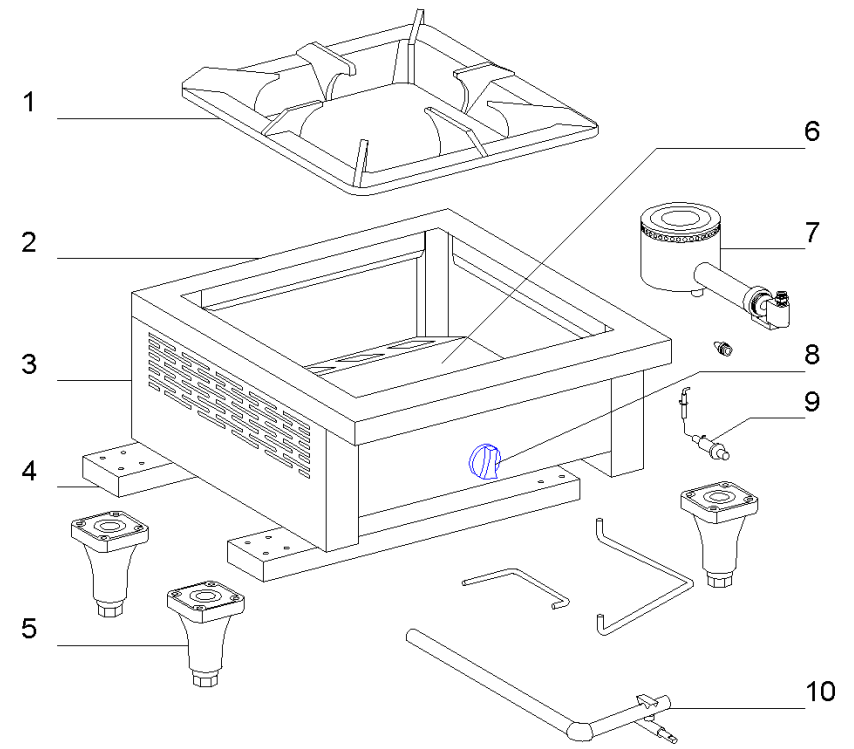

**Made in France**



# GAS STOVES GAR 14 XL

Congratulations for the acquisition of this upmarket appliance made in France. You chose an appliance which alloys the best technical qualities with a big user-friendliness. We wish you the biggest contentment

Nomenclature **RECHAUD GAR 14 XL**  
Spare parts **STOVE GAR 14 XL**

Rep	Code	Qty	Pièce	Spare part
1	B02048	1	Grille fonte	Cast iron grid
2	54100	1	Cadre	Frame
3	54101	2	Côté Droit/gauche	Right/left side
4	54103	2	Traverse	Strut
5	A13008	4	Pied	Foot
6	54105	1	Support brûleur	Burner holder
7	E01015	1	Brûleur complet	Burner assembly
8	A14075	1	Bouton	Knob
9	E02215	1	Piezo	Piezo
10	E02246	1	Rampe complète	Main supply assembly
	E02218	1	Robinet	Tap

## **1. SECURITY INSTRUCTIONS**

Please respect these instructions scrupulously to avoid any risk of fire, scald or other wounds and damage. During the use of this appliance, fundamental circumspection of security must always be noticed, such as:

- Take into account the instructions to be systematically kept with the appliance.
- Install the appliance always in instructions respect. A 10 cm distance minimum with the partition or the wall is necessary.
- Protect the appliance from direct light of the sun, frost and humidity.
- Never leave the appliance within the reach of children or disabled persons without surveillance.
- Never move the appliance when it is working or when the surfaces of cooking are still hot.
- Do not touch the hot surfaces of the appliance. The temperature of the hot surfaces can be very important when the appliance is working. Always use handles and control knobs.
- Do not use the appliance for other functions than determined use.
- Do not leave the pipe or hose (purchased separately from a specialised shop) in the contact of hot surfaces.
- Do not bend the pipe or hose
- The appliance should not be used close to combustible materials.
- During use, look after not to obstruct hearings of aeration of the appliance
- Entrust compensations only to a skilled person.
- Use only spare parts of origin.
- At the end of cooking, before cleaning the appliance, do not forget to disconnect the gas inlet.

## **2. CONTENTS OF CARDBOARD PACKAGING**

Device: A gas stove

- Accessories: - A set of natural gas injectors (burner + pilot light)  
- The present note



1 Power control knob

2 Piezo

See exploded view for GAR 14 XL at the end of the document.

### **3. CONFORMITY OF USE**

Use the device only to cook or keep warm some food.

### **4. WAY OF FUNCTIONING**

This big and multifunction gas stove is made for classical gas cooking and for gas wok cooking thank to its reversible cast iron grid.

The control of the cooking area is made with a system of piezo when starting and safety thermocouple. It is fitted with several removable parts: cast iron grid, stainless steel container burner holder (in 1 piece) and burner ring.

To turn on the gas stove, just switch on the burner by pressing on the power control knob (n°1 on picture) opposite the star position for a few seconds and on the piezo (n°2 on picture) several times if required.

Keep the control knob (n°1 on picture) pressed for 15 seconds. The burner then remains lit.

While cooking, the temperature can be regulated using the control knob (n°1 on picture) from high flame to low flame in order to avoid over-cooking.

The damage due to shocks, bad weather is not flatware by the guarantee. The material travels at the risks of the user; in case of delivery by carrier, the consignee has to have reservations towards the carrier before any delivery of the device.

The guarantee comes to an end in case of intervention, of repair, of modification by no qualified persons, or of use in inappropriate purposes.

## **6. CLEANING AND MAINTENANCE**

Cut the gas supply.

- Let cool completely the device before any technical intervention or cleaning.
- For cleaning, only use non-abrasive products, clean regularly the external walls of your device with warm water and wash liquid: avoid the abrasive towelling. Rinse your device with a wet sponge.
- Never clean the device under a water jet, the infiltrations would risk to damage it in a irreparable way.
- During a prolonged non-use, we recommend you strongly to keep the device shielded from the humidity .

## **7. TECHNICAL SPECIFICATIONS**

<b>Model</b>	<b>Outside dimensions</b>	<b>Power</b>	<b>Nb of burners</b>	<b>Weight</b>
GAR 14 XL	600x630x425 mm	14 kW	1 fire 14 kW	30 Kg

## **8. GUARANTEE**

### **Conditions of guarantee**

The guarantee applicable to any device is the commercial guarantee of the distributor or the retailer. Please contact the store where you bought your device to know the precise conditions.

The guarantee grants no right for damages.

The dispositions which follow are not exclusive of the profit of the legal guarantee planned by articles 1641 and following ones of the Civil code relative to the defects and the latent defects.

### **Exclusion clauses of the guarantee**

**Bad installation and bad maintenance, in particular if they do not respect current regulations or instructions appearing in this user guide.**

Cannot benefit from the guarantee the repairs required as a result of false operations, of inappropriate use, of carelessness or of excess loads of the device, as well as those resulting from defective installations.

A safety thermocouple cuts the gas supply if the burner is extinguished. The low flame of the appliance is pre-adjusted in the factory, it must not be changed.

## **5. FUNCTIONING / HANDLING**

### **a) Installation/Assembly:**

- Unpack carefully the machine from its packaging.
- Place the device on a plane and heatproof surface in a well ventilated place.
- Never place the device near a wall or near a partition makes of combustible materials even if it is very well isolated.
- A distance of minimum 10 cm with the partition or the wall is necessary.
- Remove the protective film from the machine.

### **b) First starting:**

During the first use, warm your machine up outside during about 30 min to evacuate residual smokes of manufacturing oil from the metallic parts. This may emit a slight smell for a few moments.

### ***First cleaning***

Clean the device before the first use. (See 6 Cleaning)

### ***Gas connection***

The appliances run on the following gases: Butane G30, Propane G31, Natural gas G20/G25. The appliances are originally delivered with a Butane/Propane injector corresponding to the category II2E+3+. The connection is made thanks to a thread 3/8.

The heat release rate of the appliance is      GAR 14 XL      14 kW

For a use in natural gas, change the injectors. They are delivered in a small plastic bag in the package. Unscrew completely the nut and then the injector inside the hole.

Connect the appliance to the gas supply pipe, interposing a stop valve which enables the appliance to be insulated from the rest of the installation.

Check the supply pressure using a manometer when all the burners are lit. It must be equal to the indications on the rating plate.

The fresh air flow required for combustion air supply is:

- GAR 14 XL      25.9 m<sup>3</sup>/h

## General conditions of installation

The installation and maintenance of the appliance must be carried out in compliance with the statutory texts and good practices in force, mainly:

### General specifications

For all appliances:

**Article GZ** Installation with combustible gases and liquefied hydrocarbons.

Then, according to use:

**Article CH** Heating, ventilation, refrigeration

Air conditioning and domestic hot water steam generation.

**Article GC** Installation of appliances to be used for catering

Specific provisions for each type of establishment to which the public is admitted (hospitals, shops, etc...)

**Important: Never change the diameter of the injectors.**

**Gas category table, according to the country of destination of the appliance.**

Country of destination	Category	Gas	Pressures	Diameter of injector
FR/BE	II2E+3+	G20/G25 G30/G31	20/25 28-30/37	320 195
LU/DE	I2E	G20	20	320
AT/CH/CY/DK/EE/FI/ HR/LT/LV/RO/SE/SI/ SK/TR	II2H3B/P	G20 G30/G31	20 30	320 195
PL	II2E3P	G20 G31	20 37	320 195
HR/HO	II2H3P	G20 G31	20 37	320 195
CH/CY/CZ/ES/GB/ GR/IE/IT/PT/SI/SK/ TR	II2H3+	G20 G30/G31	20 28-30/37	320 195
NL/NO/HU	I3B/P	G30/G31	30	195

## **Air adjustment**

Injectors were conceived to avoid any air adjustments and that whatever the gas you use.

## **c) Use of device :**

### **Elements of command and display**

Command/Display	Function
Power control knob (n°1 on picture)	On/off Set the power (low flame = low power, high flame = high power)
Piezo (n°2 on picture)	Switch on the machine

### **Switching-on**

Press the power control knob (n°1 on picture) for a few seconds in front of star position.

Press the piezo(n°2 on picture)

Keep the control knob (n°1 on picture) pressed for 15 seconds.

The burner then remains lit and it is now possible to increase the power by turning the power control knob (n°1 on picture).

### **Temperature setting**

Once the burner is lit; set the appliance to the desired power by turning the control knob (n°1 on picture).

**It is not necessary to leave the device switched on at full power. It is necessary to adapt the temperature to products to be cooked to limit the gas consumption.**

### **Stopping the appliance**

Set control knob (n°1 on picture) to 0: the appliance is completely switched-off.

Close the butane or propane cartridge

Let the device cool.

Clean the appliance. (See 6. Cleaning)

## **d) Breakdown / repair:**

In case of breakdown or of damaged part, please call your after-sales service and confide any technical operation to qualified person.

When you contact the after-sales service of your distributor or your store, give him the complete reference of your device (commercial name, type and serial number). This information appears on the visible descriptive plate behind the device.